

**ARS**   
*Cut Above the Rest*

 **MADE IN JAPAN**



# CATALOG

ARS TOOLS. JAPANESE TOP QUALITY CUTTING AND SAWING TOOLS.



VIEW ALL THE DETAILED PRODUCT INFORMATION AT [WWW.ARSTOOLS.EU](http://WWW.ARSTOOLS.EU)

# ARS Tools. Japanese top quality

## User

What is important when using products? Right, a top product at an affordable price, a high level of quality, good service from the manufacturer and a satisfied feeling.

An ARS customer gets a product that matches the high level of expectations of today's user. Only with these qualities can ARS compete. If you go for quality and want only the best, you have come to the right place with ARS!

## Quality

ARS has long been known as the most exclusive and high-quality pruning tools, for both the professional user and the quality-conscious individual. Using only high-quality steel, ARS excels with its quality.

For almost all ARS products, all parts are available separately. ARS stands for quality and offers the user a guarantee against manufacturing defects for up to 25 years!

## Future

With its sophisticated supply programme, ARS is truly at home in all markets. ARS is the only supplier in the world with such a high-quality and at the same time broad package, making it unique of its kind.

Through constant refinement of the quality and expansion of the ARS is always one step ahead. ARS guarantees every user a good result for now and in the future!

## Steel grade

ARS has worked with various steel manufacturers to develop the most suitable steel developed for its products. The steel must meet ARS's high standard, which is above that of the JIS (Japan Industrial Standard).

## Hard chromed

This method offers high hardness, rust resistance, sharp looks and superior durability. The smooth surface also prevents juices sticking to the blades, ensuring maximum performance of your ARS tools.

## Design and ergonomics

Ergonomics, economy and durability are key features of ARS products, which are developed by experienced, trained professionals.

## Impulse hardened

The innovative "Impulse Hardening" method, involves heating and cooling the steel, within thousands of a second, by using the impact of high-frequency current. This makes it enabled to achieve hardness from 900HV to 950HV on the Vicker scale while maintaining high elasticity. Impulse hardened blades therefore last about three times longer under normal conditions.

## ARS sharpening method

ARS saw blades are thinner at the back of the blade and thicker at the saw teeth, ensuring minimal resistance. The blades are sharpened by fully automated grinding machines, to always achieve the same, perfect result.



## ARS, very well-tested!

The German "Kuratorium für Waldarbeit und Forsttechnik" KWF, has tested several ARS products tested. These were pruning shears, hand saws and pole saws that were subjected to a thorough test in German forestry. All tested products were awarded the coveted KWF seal of approval.

In this ARS catalogue, you will be able to find all these products, accompanied by the seal of approval. We cordially invite you to use these products in person and convince yourself of ARS quality.



Product line	4 - 5
Pruning shears	6 - 9
Telescopic long reach shears	10 - 11
Long reach shears	12 - 13
Loppers	14 - 15
Hedge trimmers	16 - 17
Pruning saws	18 - 22
Foldable pruning saws	23
Telescopic poles	24
EXP-series	25
EXP saw assembly	26 - 27
Pruning at height	28 - 29
Harvesting shears	30 - 31
Craft scissors	32 - 33
For the florist	34
Accessories	35
Promotion	36 - 37
Notes	38
Terms & conditions	39

Product icons	
<b>H</b> Hard chromed	Turbocut
<b>B</b> Black coated	Super Turbocut
<b>N</b> Chemical nickel plated	Impulse hardened
<b>F</b> Fluorocarbon coated	Tooth setting (mm)
<b>C</b> Carbon hardened steel	Tooth thickness (mm)
<b>S</b> Stainless steel	Total length (mm)
Curvature ground	Weight (gram)
Taper ground	Spare blade
Quality label from the German KWF	Max. pruning thickness (mm)
Packaging	Spare parts available
	Size of hands



# ARS, the most exclusive and high-quality pruning tools

## Pruning shears

Ergonomics comes naturally with ARS secateurs. A complete range of secateurs for all kinds of pruning work for the professional user. Using only high-quality steel, ARS excels in quality.

## Loppers

Loppers in various sizes with varying cutting capacities. Due to the friction-reducing coating, cutting with ARS is super easy.

## Hedge trimmers

Craftsmanship requires specialist tools, comfortable handles and razor-sharp blades for a clean cut: so ARS!

## Scissors

The original ARS fruit cutters are available in various versions available, in both red and the unique HACCP blue. Much imitated, but not equalled. You will also find a large collection of scissors for various jobs.

## Long reach shears

With ARS long-arm shears, you will find only quality, for pruning work at great heights. The unique long-arm shears are available in various lengths and designs.

Visit [www.arstools.eu](http://www.arstools.eu) for all detailed product information



## Pruning saws

A wide variety of pruning saws of very high quality. A class product, for its innovative tooth setting and friction-reducing notches. ARS is the inventor of the "PULL SAW" method or the pull saw.

## Telescopic poles and pole saws

Should you not be able to work high enough with the long arm saws, you certainly can with the telescopic handles and pole saws, as the length varies from 1.4 to as much as 5.6 metres. Using only high-quality steel, lightweight aluminium and the unique tothing also makes cutting at height easier.



HEADQUARTERS IN OSAKA, JAPAN





# VS-series

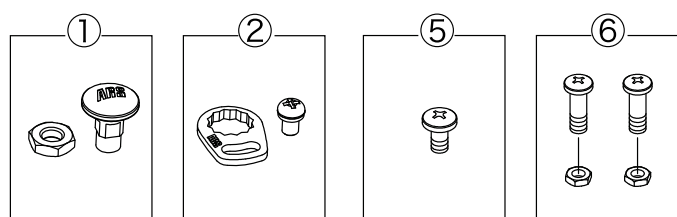
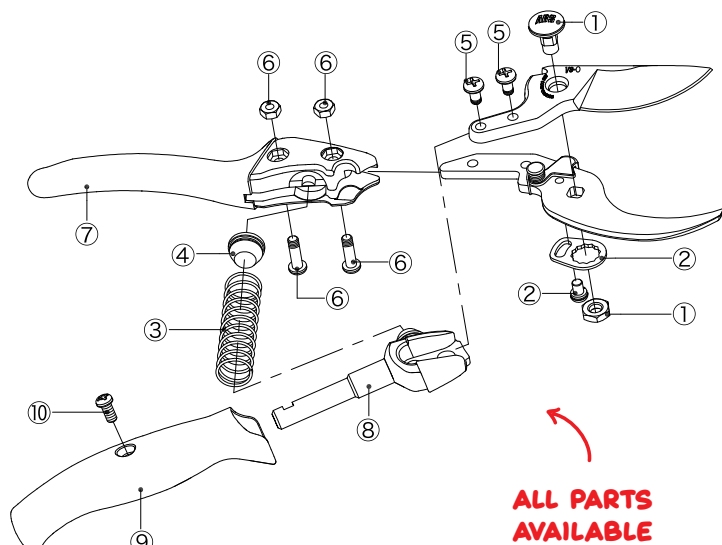

**VS-7XR** 5/50  
 EAN 4965280679345  
 Pruning shears 180 mm, S, rotating handle, red/black  
 H C 180 250 VS-7X-2 / VS-7X-3 19 kwf



**VS-8XR** 5/50  
 EAN 4965280679390  
 Pruning shears 200 mm, M, rotating handle, red/black  
 H C 200 265 VS-8X-2 / VS-8X-3 22 kwf



**VS-9XR** 5/50  
 EAN 4965280679529  
 Pruning shears 227 mm, L, rotating handle, red/black  
 H C 227 310 VS-9X-2 / VS-9X-3 25 kwf



### Unlocked by squeezing

The safety lock is designed so that the scissors do not unlock unintentionally in the holster or pocket and do not lock while pruning.



### Ergonomics

The rotating handle moves with the fingers with every pruning motion, eliminating friction eliminated. This prevents blisters and reduces injuries.

### Replaceable parts

The extra-hardened and hard chrome-plated upper blade, or even the entire pruning head, is easy to replace.



**VS-7XZ** 5/50  
 EAN 4965280679338  
 Pruning shears 180 mm, S, red  
 H C 180 212 VS-7X-2 / VS-7X-3 19 kwf

**VS-8XZ** 5/50  
 EAN 4965280679383  
 Pruning shears 200 mm, M, red  
 H C 200 220 VS-8X-2 / VS-8X-3 22 kwf

**VS-9XZ** 5/50  
 EAN 4965280679512  
 Pruning shears 227 mm, L, red  
 H C 227 257 VS-9X-2 / VS-9X-3 25 kwf



**New in 2024!**  
**FB-7** 5/50  
 Pruning shears 180 mm, S, red  
 H C 180 180 19 kwf

**New in 2024!**  
**FB-8** 5/50  
 Pruning shears 230 mm, M, red  
 H C 230 200 22 kwf



**New in 2024!**  
**CB-8Z** 5/50  
 Pruning shears 200 mm, S, red  
 H C 200 190 CB-8Z-1 / CB-8Z-2 / CB-8Z-3 22 kwf

**New in 2024!**  
**CB-9Z** 5/50  
 Pruning shears 230 mm, M, red  
 H C 230 210 CB-8Z-1 / CB-8Z-2 / CB-8Z-3 25 kwf



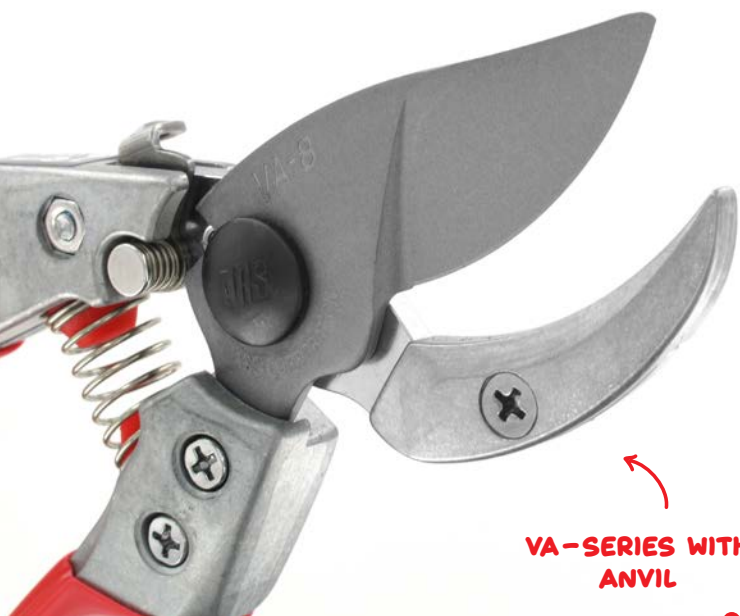

VA-SERIES WITH ANVIL

# VA-series

The ARS pruning shears range includes two anvil models: the VA-7Z and VA-8Z. These ergonomic pruning shears have fluorocarbon-coated blades and are balanced to reduce fatigue during prolonged use. The anvil makes it easier to cut thick branches. This secateurs is also very suitable for left-handed use.

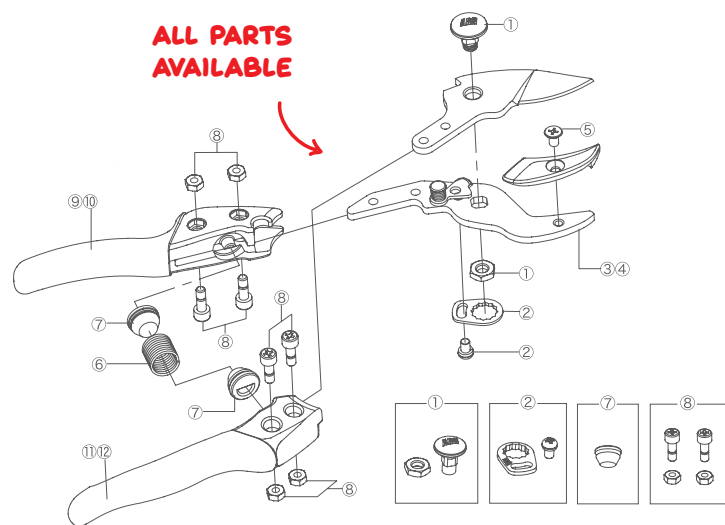

ALSO FOR LEFT-HANDED USE



**VA-7Z** 5/50  
Pruning shears 180 mm, anvil, red  
EAN 4965280679703  
F C 180 215 VA-7Z-1 22



**VA-8Z** 5/50  
Pruning shears 205 mm, anvil, red  
EAN 4965280679741  
F C 205 235 VA-8Z-1 22

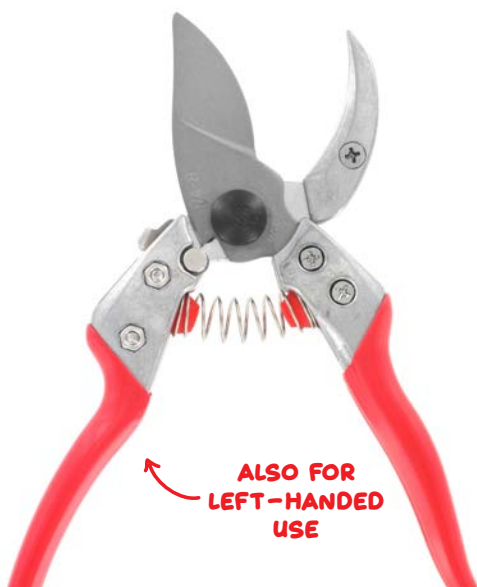

**CB-8** 5/50  
Pruning shears 205 mm, red/black  
EAN 4965280651501  
N C 205 210 CB-8-1 / CB-8-2 22



**CB-9** 5/50  
Pruning shears 225 mm, red/black  
EAN 4965280651600  
N C 225 230 CB-9-1 / CB-9-2 25



**120EU-R**  
Rose pruner 210 mm, red  
EAN 4965280652089  
H C 210 230 5/50 10



**140DX**  
Pruning shears 184 mm, red  
EAN 4965280656087  
H C 184 150 5/50 12



**120DX**  
Pruning shears 195 mm, red  
EAN 4965280652003  
H C 195 160 5/50 22



**130DX**  
Pruning shears 184 mm, red  
EAN 4965280654083  
H C 184 165 5/50 19



**140L-DX**  
Pruning shears 200 mm, white  
EAN 4965280656803  
H C 200 150 5/50 12



**120EU**  
Pruning shears 210 mm, red  
EAN 4965280652027  
H C 210 230 5/50 22



**130DX-G**



**130DX-V**



**130DX-P**



**130DX-W**



**130DX-Y**



# Cut and Hold

## ZF-series

- Light weight
- Telescopic
- Extremely rigid
- Ergonomic design
- 180° rotatable handle
- Pruning up to 5 meters in height

160-SERIES WITH CUT & HOLD



CUT & HOLD



180-SERIES WITHOUT CUT & HOLD

↑ TELESCOPIC - FROM 1260 MM TO 2010 MM ↓



CUT & HOLD

↑ TELESCOPIC - FROM 1762 MM TO 3010 MM ↓



↑ TELESCOPIC - FROM 1260 MM TO 2010 MM ↓



↑ TELESCOPIC - FROM 1762 MM TO 3010 MM ↓



180° ROTATABLE HANDLE

### Long reach features

ARS long arm shears are made of lightweight aluminium. The cutting blades are hardened chrome-plated, making them resistant to corrosion. The comfortable handles are ergonomic and therefore reduce the risk of injury.

The 180° rotating handle allows you to determine the correct pruning position without putting unnecessary strain on the wrist.

The 160 series consists of a number of long-arm pruning shears, which are equipped with a cutting head with grip blocks, called "Cut & Hold". This allows you to collect the cut products such as fruit and flowers in a controlled way.

The 180 series consists of a number of long arm pruning shears which are equipped with a cutting head suitable for all pruning work at height.

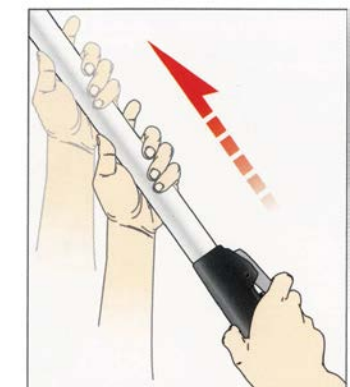

**160ZF-2.0-3** 2/10 EAN 4965280684554  
 Telescopic cut & hold pruner 1260 - 2010 mm, red/grey  
 H C 1260 ~ 2010 950 160ZR-1 10

**160ZF-3.0-5** 2/10 EAN 4965280684561  
 Telescopic cut & hold pruner 1762 - 3010 mm, red/grey  
 H C 1762 ~ 3010 1200 160ZR-1 10

**180ZF-2.0-3** 2/10 EAN 4965280733597  
 Telescopic pruner 1260 - 2010 mm, red/grey  
 H C 1260 ~ 2010 935 180ZR-1 20

**180ZF-3.0-5** 2/10 EAN 4965280733603  
 Telescopic pruner 1762 - 3010 mm, red/grey  
 H C 1762 ~ 3010 1185 180ZR-1 20





160 SERIES WITH CUT & HOLD

# Cut & hold shears



**160-0.35** 2/10 EAN 4965280685407

Rose pruner 350 mm, cut & hold, red/grey  
 H C 350 340 160-1 10

**160-0.6** 2/10 EAN 4965280685506

Long reach cut & hold shears 600 mm, cut & hold, red/grey  
 H C 600 395 160-1 10

**160-1.2** 2/10 EAN 4965280685605

Long reach cut & hold shears 1200 mm, cut & hold, red/grey  
 H C 1200 560 160-1 10

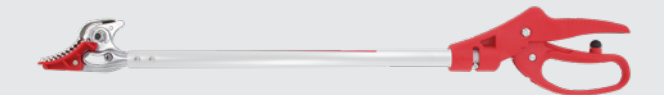

**150-0.6** 2/10 EAN 4965280685193

Rose pruner 617 mm, cut & hold, red/grey  
 H C 617 325 150-1 10



Handle is not rotatable EAN 8715397007496

**160U-0.7** 2/10

Lily pruner 700 mm, red/grey

H C 700 405 160U-1 15



**180-1.2** 2/10 EAN 4965280735102

Long reach pruning shears 1200 mm, red/grey

H C 1200 575 180-1 20

**180-1.8** 2/10 EAN 4965280735201

Long reach pruning shears 1800 mm, red/grey

H C 1800 740 180-1 20

**180-2.4** 2/10 EAN 4965280735300

Long reach pruning shears 2400 mm, red/grey

H C 2400 865 180-1 20

180° ROTATING HANDLE



180-SERIES WITHOUT CUT & HOLD

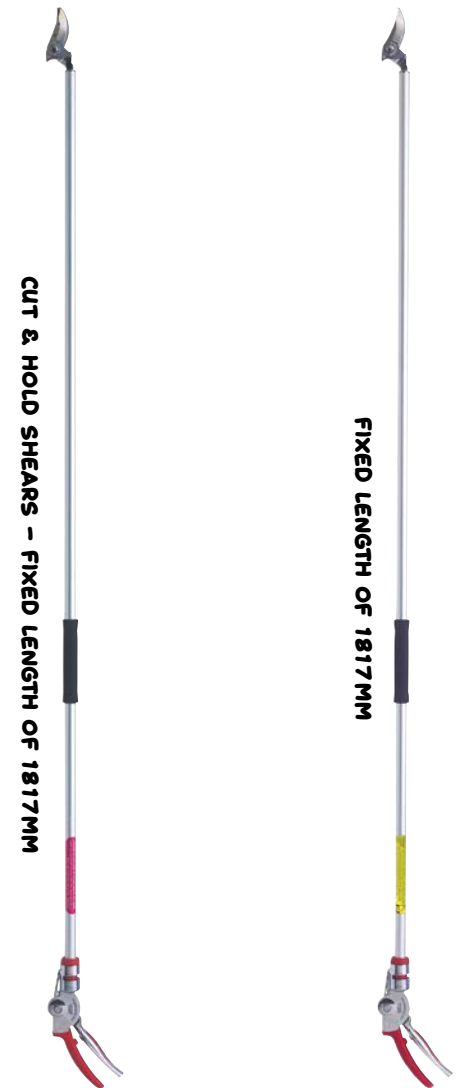

**160R-1.8** 2/10 EAN 4965280685216

Long reach cut & hold shears 1817 mm, cut & hold, red/grey

H C 1817 710 160ZR-1 10

**180R-1.8** 2/10 EAN 4965280735300

Long reach pruning shears 1817 mm, red/grey

H C 1817 695 180ZR-1 20

For heavier pruning work



**180LR-1.2** 2/10 EAN 4965280444516

Long reach pruning shears 1246 mm, red/grey

H C 1246 730 180L-1 22

**180LR-1.8** 2/10 EAN 4965280444523

Long reach pruning shears 1846 mm, red/grey

H C 1846 870 180L-1 22

**180LR-2.1** 2/10 EAN 4965280444530

Long reach pruning shears 2146 mm, red/grey

H C 2146 950 180L-1 25





### LP-series

- Light weight
- Oval handles
- Double bumper
- Forged blades
- Carbon hardened steel
- Up to Ø 50mm branch thickness



**LPB-20S** 1/10  
EAN 4965280448293  
Loppers 476 mm, red/grey  
B C 476 825 LPB-20-1 / LPB-20-2 30



**LPB-20M** 1/10  
EAN 4965280448309  
Loppers 624 mm, red/grey  
B C 624 940 LPB-20-1 / LPB-20-2 32



**LPB-20L** 1/10  
EAN 4965280448316  
Loppers 772 mm, red/grey  
B C 772 1055 LPB-20-1 / LPB-20-2 34



**LPB-20-1**  
Suitable for LPB-20 serie



**LPB-20-2**



**LPB-30S** 1/10  
EAN 4965280448323  
Loppers 482 mm, red/grey  
B C 482 860 LPB-30-1 / LPB-30-2 34



**LPB-30M** 1/10  
EAN 4965280448330  
Loppers 630 mm, red/grey  
B C 630 1020 LPB-30-1 / LPB-30-2 36



**LPB-30L** 1/10  
EAN 4965280448347  
Loppers 778 mm, red/grey  
B C 778 1135 LPB-30-1 / LPB-30-2 38



**LP-40** 1/10  
EAN 4965280448231  
Loppers 800 mm, XL, red/grey  
F C 800 1720 LP-40-1 / LP-40-2 50



**LPA-30L** 1/10  
EAN 4965280448262  
Loppers 806 mm, XL, red/grey  
C 806 1130 LPA-30-1 / LPA-30-2 45



**LPB-30-1**  
Suitable for LPB-30 serie



**LPB-30-2**



Long reach loppers

**185-1.5** 10  
EAN 4965280683700  
Long reach loppers 1500 mm  
F C 1500 1550 185-1 45

**185-1.8** 10  
EAN 4965280683731  
Long reach loppers 1800 mm  
F C 1800 1690 185-1 45





**KR-1000L** 5/20 EAN 4965280681058  
 Hedge trimmer 750 mm with a blade length of 180 mm, red/grey  
 H C 750 840 KR-1000-1 10



**K-800** 5/20 EAN 4965280682512  
 Hedge trimmer 500 mm with a blade length of 150 mm, red/grey  
 N C 500 550 6



← TELESCOPIC - FROM 720MM TO 1050 MM →

**K-900Z** 5/20 EAN 4965280682543  
 Telescopic hedge trimmer 720 - 1050 mm with a blade length of 150 mm, red/grey  
 N C 720 ~ 1050 980 6



**KR-1000** 5/20 EAN 4965280681027  
 Hedge trimmer 653 mm with a blade length of 180 mm, red/grey  
 H C 653 780 KR-1000-1 10



**KR-1000**

The hard chrome-plated, double-ground and replaceable blades ensure optimal results. This innovative ultra-lightweight hedge trimmer with ergonomic, slightly curved handles offer you maximum comfort. All ARS hedge trimmers are precision tools and are ideal for fine work.

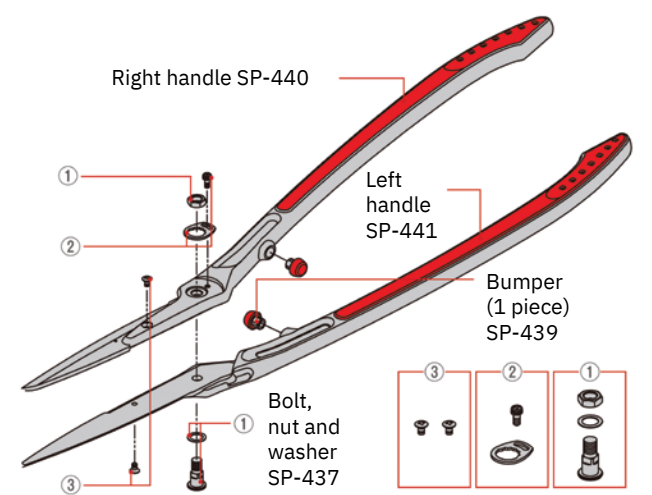





**TL-24** 5/50  
 EAN 4965280045003  
 Pruning saw, adjustable in two positions, with a blade of 240 mm + holster, black/grey  
 N C [Icons] 406 190 TL-24-1 95 kwf



**TL-27** 5/50  
 EAN 4965280046000  
 Pruning saw, adjustable in two positions, with a blade of 270 mm + holster, black/grey  
 N C [Icons] 437 200 TL-27-1 105 kwf



**TL-30** 5/50  
 EAN 4965280047007  
 Pruning saw, adjustable in two positions, with a blade of 300 mm + holster, black/grey  
 N C [Icons] 465 210 TL-30-1 120 kwf

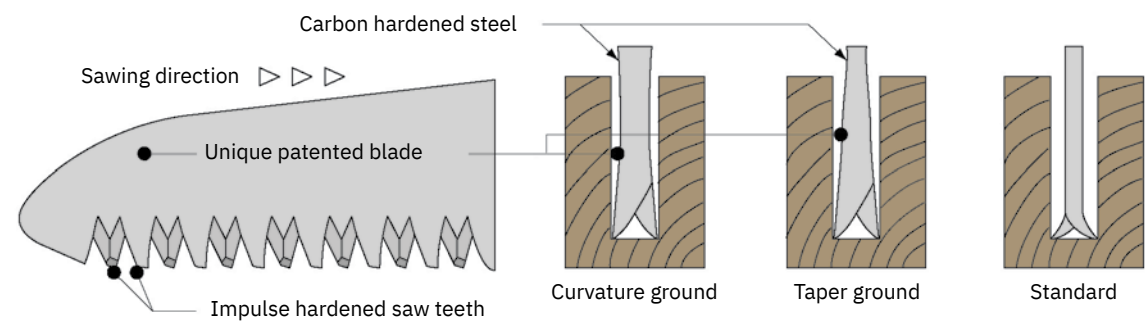

- Minimum resistance
- Clean cut
- Ergonomic design
- Pull-Saw method
- Interchangeable saw blades
- Significantly longer sharpness

**Triple ground teeth**

The taper and curvature ground ARS blades are precisely shaped and have a razor-sharp tooth setting. The uniquely patented blades leave a remarkably clean cut. Due to the very sharp teeth and the patented sharpening method, a pulling sawing motion ("Pull-Saw" method) requires much less effort compared to conventional pruning saws. The hard chrome-plated blades offer high hardness, rust resistance, sharp looks and superior durability. The smooth surface also prevents juices from sticking to the blades.



**UV-32E** 5/50  
 EAN 4965280444233  
 Pruning saw with a blade of 320 mm + holster, red/black  
 H C [Icons] 500 420 UV-32E-1 125 kwf



**UV-32E-W** 5/50  
 EAN 4965280439086  
 Pruning saw with a blade of 320 mm + holster, red/black  
 H C [Icons] 500 420 UV-32E-1 125 kwf

**What is Super Turbocut?**

The Super Turbocut saw blades have an extra notch, a fine tooth setting and are extra sharpened. The notches ensure that the trimmings are removed more easily. This is particularly beneficial when cutting wet or fresh wood.



**CAM-18PRO** 5/50  
 EAN 4965280025012  
 Pruning saw PRO with a blade of 180 mm + holster, red/black  
 H C [Icons] 360 250 18PRO-1 70 kwf



**CAM-24PRO** 5/50  
 EAN 4965280028013  
 Pruning saw PRO with a blade of 240 mm + holster, red/black  
 H C [Icons] 414 280 24PRO-1 95 kwf







**CT-37PRO** 5/50 EAN 4965280439123  
 Pruning saw PRO with a blade of 370 mm + holster, grey/black  
 H C 545 580 CT-37PRO-1 145

**CT-42PRO** 5/50 EAN 4965280439147  
 Pruning saw PRO with a blade of 420 mm + holster, grey/black  
 H C 600 600 CT-42PRO-1 165

**CTR-32PRO** 5/50 EAN 4965280439161  
 Pruning saw PRO with a blade of 320 mm + holster, grey/black  
 H C 480 430 CTR-32PRO-1 125



**Impulse hardened**  
 The innovative "Impulse Hardening" method, involves heating and cooling the steel, within thousands of a second, by using the impact of high-frequency current. This makes it enabled to achieve hardness from 900HV to 950HV on the Vicker scale while maintaining high elasticity. Impulse hardened blades therefore last about three times longer under normal conditions.



**UVR-32PRO** 5/50 EAN 4965280439185  
 Pruning saw PRO with a blade of 320 mm + holster, grey/black  
 H C 480 430 UVR-32PRO-1 125



**CT-32E-W** 5/50 EAN 4965280439086  
 Pruning saw PRO with a blade of 320 mm + holster, wood  
 H C 500 420 CT-37PRO-1 125



**UV-37PRO** 5/50 EAN 4965280444028  
 Pruning saw PRO with a blade of 370 mm + holster, grey/black  
 H C 545 580 UV-37PRO-1 145

**UV-42PRO** 5/50 EAN 4965280444042  
 Pruning saw PRO with a blade of 420 mm + holster, grey/black  
 H C 600 600 UV-42PRO-1 165



**PRO-ST** 5/50 EAN 4965280997142  
 Set of two legstraps for PRO-serie saws, 580 mm, black  
 580







**CAM-18LN** 10/50 EAN 4965280425607  
Pruning saw with a blade of 180 mm + holster, red  
N C 4 12 336 170 18LN-1 70



**CAM-24LN** 10/50 EAN 4965280428608  
Pruning saw with a blade of 240 mm + holster, red  
N C 4 13 432 240 24LN-1 95



**DUKE-25** 10/50 EAN 4965280448002  
Pruning saw with a blade of 250 mm + holster, red  
N C 4 12 420 250 ARSDUKE-25-1 100



**PS-25KL** 10/50 EAN 4965280413802  
Pruning saw with a blade of 250 mm, wood  
H C 4 13 415 140 25KL-1 100

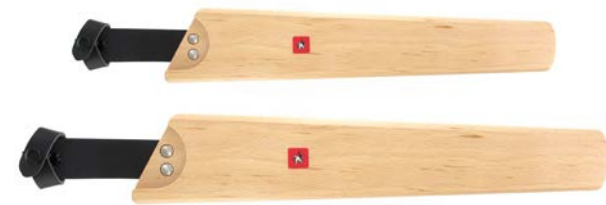

**SH-25** Holster for PS-25KL, wood  
**SH-32** Holster for PS-32LL, wood



**PS-32LL** 10/50 EAN 4965280420701  
Pruning saw with a blade of 345 mm, wood  
H C 5 13 550 230 32LL-1 135



**G-17** 5/50/100 EAN 4965280440020  
Foldable pruning saws with a blade of 170 mm, red/black  
H C 4 12 379 175 G-17-1 65



**GR-17** 5/50/100 EAN 4965280440037  
Foldable pruning saws with a blade of 170 mm, red/black  
H C 4 12 377 175 GR-17-1 65



**G-18L** 5/50/100 EAN 4965280440006  
Foldable pruning saws with a blade of 180 mm, red  
H C 4 12 410 160 18L-1 70



**GR-18L** 5/50/100 EAN 4965280440013  
Foldable pruning saws with a blade of 180 mm, red  
H C 4 12 410 165 18R-1 70



**210DX** 5/50/100 EAN 4965280005007  
Foldable pruning saws with a blade of 165 mm, red  
H C 4 12 350 140 211 60



Foldable pruning saws



**PM-21** 5/50 EAN 4965280001603  
Foldable pruning saws, adjustable in two positions, with a blade of 210 mm, black  
H C 4 13 440 180 PM-21-1 70



**PM-24** 5/50 EAN 4965280001627  
Foldable pruning saws, adjustable in two positions, with a blade of 240 mm, black  
H C 4 13 500 215 PM-24-1 80





## EXP-series

- Light weight
- Telescopic
- Extremely rigid
- Multifunctional
- Very well tested
- Sawing up to 7 meters in height



A

### Features

The hook (A) at the end of the blade is useful for removing climbing plants and cutting thin branches.

B

The SUPER Turbocut saw teeth (B) ensure effortless cutting at high altitudes. The saw is easy to change using the unique ARS click system.

C

The bark cutter (C) prevents tearing off the remaining bark after cutting the branch. It is also useful for removing thin branches and other unwanted growth. The hollow shape at the back of the bark cutter also serves as a suspension hook during work.

D

The multi-part handles (D) can be easily extended to different lengths by means of locking knobs and safety levers. can be easily extended to different lengths.

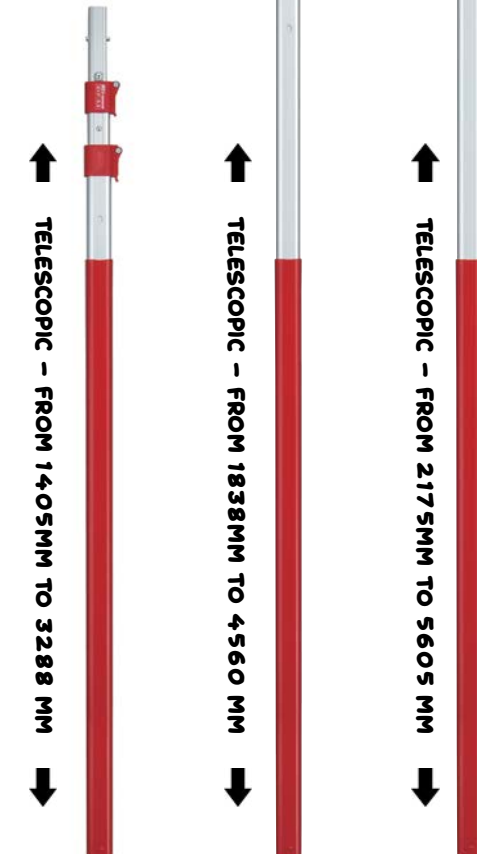

#### EXP-3.3

EAN 4965280446077

Telescopic pole EXP 1405 - 3288 mm, red/grey

1405 ~ 3288 1530 5/10



#### EXP-4.5

EAN 4965280446022

Telescopic pole EXP 1838 - 4560 mm, red/grey

1838 ~ 4560 1720 5/10



#### EXP-5.5

EAN 4965280446053

Telescopic pole EXP 2175 - 5605 mm, red/grey

2175 ~ 5605 2100 5/10



## EXW pole saws

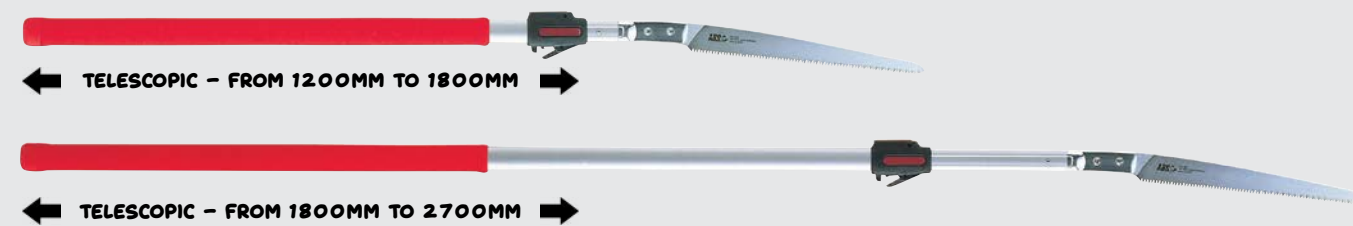

#### EXW-1.8

EAN 4965280057013

Telescopic pole saw with a blade of 300 mm, red/grey

H C 1200 ~ 1800 750 5/20 EXW-1 100

#### EXW-2.7

EAN 4965280057020

Telescopic pole saw with a blade of 300 mm, red/grey

H C 1800 ~ 2700 1030 5/20 EXW-1 100



# ARS

## Cut Above the Rest

### Assembling the right telescopic saw yourself

With a wide range of 32 cm saw blades, ARS offers the possibility to create the best combination for your job, in combination with the JG-2 and a EXP pole.



**JG-2**  5/20

140 178



**SH-32-EXP**  10

200

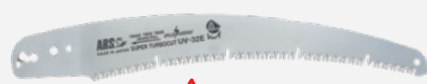

**SUPER TURBOCUT**

**UV-32E-1**  10/100  125

      320 390 



**CTR-32PRO-1**  10/100  125

      320 390 



**SUPER TURBOCUT**

**UVR-32PRO-1**  10/100  125

      320 390 



**CT-32E-1**  10/100  125

      320 390 

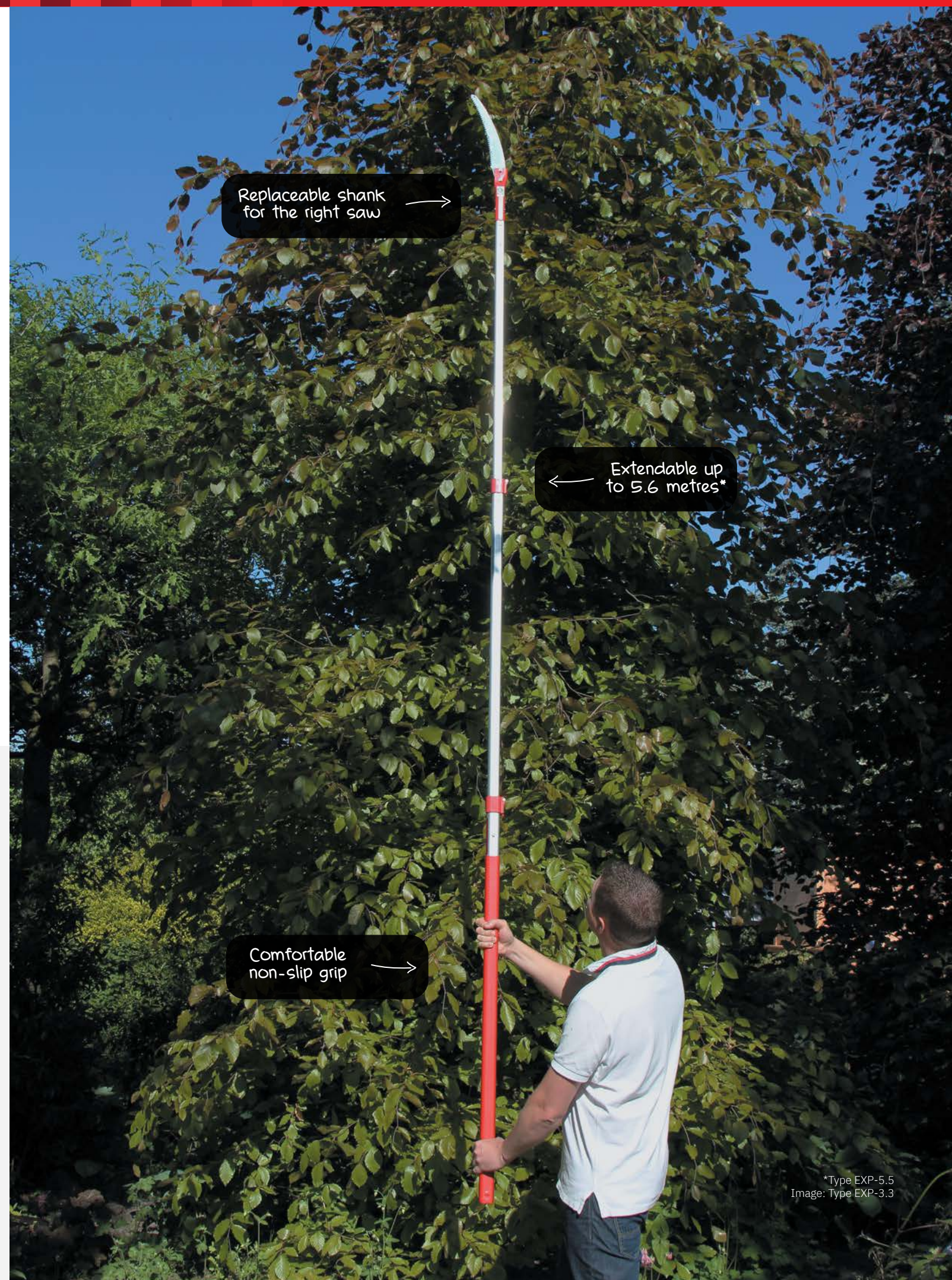

Replaceable shank for the right saw →

← Extendable up to 5.6 metres\*

Comfortable non-slip grip →

\*Type EXP-5.5  
Image: Type EXP-3.3





**UV-40** 5/20  
EAN 4965280445001  
Pruning saw with a blade of 400 mm for EXP poles + holster, red

Icons: H, C, A, 4.5, 1.5, 630, 520, UV-40-1, 160, kwf



**UV-34** 5/20  
EAN 4965280444202  
Pruning saw with a blade of 340 mm for EXP poles, red

Icons: N, 4.0, 1.5, 560, 390, UV-34-1, 135



**UV-47** 5/20  
EAN 4965280446008  
Pruning saw with a blade of 470 mm for EXP poles, red

Icons: N, 4.5, 1.6, 670, 500, UV-47-1, 185, kwf



**JGH-90** 5/50  
EAN 4965280446152  
Hook for EXP poles, grey

Icons: A, 156, 182



**K-6770-A\*** 5/20  
EAN 8715397005058  
Pruning element for EXP poles, red/black

Icons: C, B, 500, 1254, K-6770-1, 50

GEAR POWER METALLO

\*This is a Metallo product



**JG-1** 10/100  
EAN 4965280446107  
Shank for UV-40-1 / UV-47-1, red



**JG-2** 10/100  
EAN 4965280446114  
Shank for UV-34-1, UV-32E-1, UVR-32PRO-1, CTR-32PRO-1, red



**JG-3** 10/100  
EAN 4965280446121  
Shank for all saw blades (except UV-40-1), red

\*niet geschikt for EXP poles



**JG-4** 10/100  
EAN 4965280446138  
Shank for all EXP poles, red



**SH-UV** 10/50  
EAN 4965280445063  
Holster for UV-40 and UV-47, red

Icons: 535, 274



**UV-40-1** 10/50  
EAN 4965280445018  
Saw blade of 400 mm for UV-40 including bark cutter

Icons: H, C, A, 4.5, 1.5, 160



**UV-47-1** 10/50  
EAN 4965280446015  
Saw blade of 470 mm for UV-47

Icons: N, 4.5, 1.6, 185

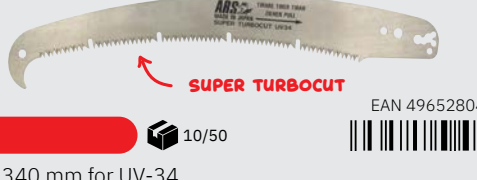

**UV-34-1** 10/50  
EAN 4965280440150  
Saw blade of 340 mm for UV-34

Icons: N, 4.0, 1.5, 135



**UV-32E-1** 10/50  
EAN 4965280444257  
Saw blade of 320 mm for UV-32E en UV-32E-W

Icons: H, C, A, 4.0, 1.2, 125, kwf



**UVR-32PRO-1** 10/50  
EAN 4965280439192  
Saw blade of 320 mm for UVR-32PRO

Icons: H, C, A, 4.0, 1.5, 125, kwf



**CTR-32PRO-1** 10/50  
EAN 4965280439178  
Saw blade of 320 mm for CTR-32PRO

Icons: H, C, A, 4.0, 1.5, 125, kwf







**300L-BL** 20/200 EAN 4965280658920  
Harvesting shears 190 mm with straight blades, blue  
B C 190 110



**300L** 20/200 EAN 4965280658005  
Harvesting shears 190 mm with straight blades, red  
B C 190 110



**300SS-BL** 20/200 EAN 4965280658937  
Harvesting shears 170 mm with straight blades, blue  
B C 170 100



**300SS** 20/200 EAN 4965280659002  
Harvesting shears 170 mm with straight blades, red  
B C 170 100

## Harvesting shears

The 300/310 series is lightweight and equipped with a non-slip handle, which is comfortable to hold. The marquenched hardened blades make the shears ideal for harvesting fruit and vegetables and cutting flowers. They are also suitable for gardening in general.



**310-D** 20/200 EAN 4965280660909  
Harvesting shears 160 mm with extra curved blades, red  
B C 160 90



**310-T** 20/200 EAN 4965280447005  
Harvesting shears 160 mm with straight blades, red  
B C 160 95



**310DX** 20/200 EAN 4965280660206  
Harvesting shears 170 mm with curved stainless steel blades, red  
S 170 110



**300L-DX** 20/200 EAN 4965280658197  
Harvesting shears 190 mm with straight stainless steel blades, red  
S 190 110



**SE-45** 10/100 EAN 4965280752000  
Harvesting shears 183 mm with straight stainless steel blades, red  
S 183 85 SE-45-1



**320B-T** 20/200 EAN 4965280663207  
Harvesting shears 155 mm with straight blades, white  
B 155 55



**320B-M** 20/200 EAN 4965280664204  
Harvesting shears 155 mm with curved blades, white  
B 155 55



**310-BL** 20/200 EAN 4965280658944  
Harvesting shears 160 mm with curved blades, blue  
B C 160 90



**320DX-T** 20/200 EAN 4965280661203  
Harvesting shears 155 mm with straight stainless steel blades, yellow  
B 155 55



**320DX-M** 20/200 EAN 4965280662101  
Harvesting shears 155 mm with curved stainless steel blades, yellow  
B 155 55





**330HN-R** 5/50/100



Craft scissors 160 mm, red/black



330HN-W



330HN-V



330HN-Y



330HN-P



330HN-G



**NH-11** 6/48

EAN 4965280854001



Aramid shears 110 mm with micro-serrated blades, red



**370** 6/72

EAN 4965280672407



Industrial shears SUPER Craft 160 mm with micro-serrated blades, black



**340H-T** 5/50/100



Craft scissors 190 mm, red



WITH WIRE CUT FUNCTION

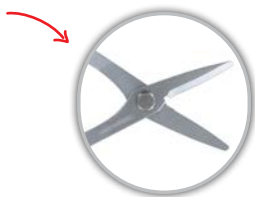

**350-T** 5/50/100



Craft scissors 158 mm, red



**350-M** 5/50/100



Craft scissors 158 mm, black



**360-M** 10/50/100



Craft scissors 125 mm, green/blue

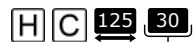

**380** 5/50/100

EAN 4965280672506



Craft scissors 195 mm, red



WITH WIRE CUT FUNCTION

**390** 10/100

Scissors heavy duty 160 mm, brown



EAN 4965280673008



Superior quality

CUTS THROUGH ARAMID  
AT LEAST 500,000  
TIMES



**ARS526-A** 5/50

EAN 4965280853004



Craft scissors 260 mm with micro-serrated blades, black

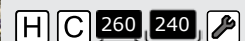

**ARS526-H** 5/50

EAN 4965280673008



Aramid shears 260 mm with micro-serrated blades, black

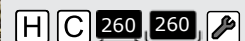





**FN-6T-R-BP**

EAN 4965280995025

Florist knife 151 mm with stainless steel blade, red/white

151 30 5/50



**IK-10-R**

EAN 4965280031518

Foldable pruning saws 220 mm with a fine tooth setting, red

220 35



**316**

EAN 4965280665003

Wire cutter 170 mm, red

170 105 10/100



**FL-18**

EAN 4965280995513

Florist scissors 180 mm with stainless steel blades, red

180 110 10/50

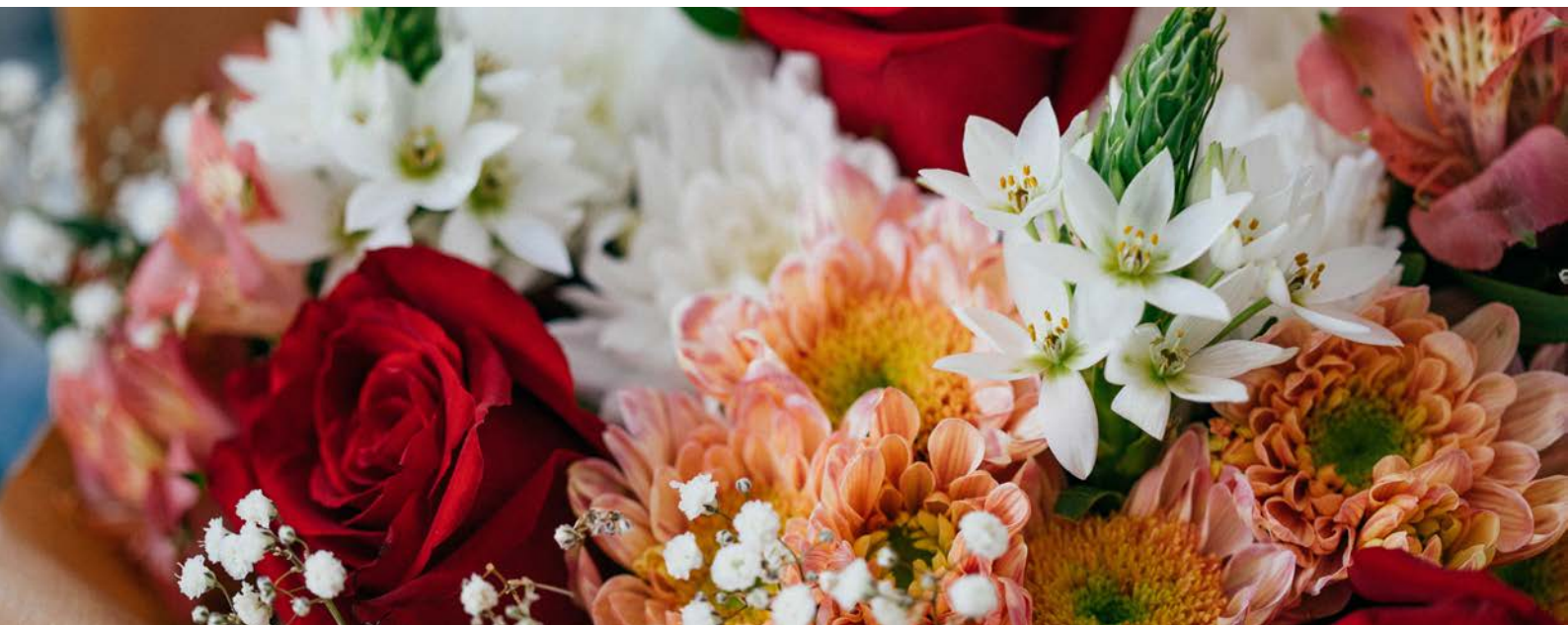

**Clean tools, healthy crop**

To optimise the life of your product, it is important to clean each tool after use and store it dry. For cleaning pruning tools, we recommend Blade Cleaner GO-1 and GO-5. When pruning trees, shrubs and plants releases juices which usually form a persistent sticky layer on the blades of saws and shears. Leave behind.

The Blade Cleaner GO-1 and GO-5 is a powerful cleaner to effectively remove such deposits from your pruning tools. Keeping your products clean makes your work easier and leaves a clean and beautiful wound on the pruned work.

Clean pruning tools reduce the risk of cross-contamination. Clean your product in 15 seconds!



**3 DIFFERENT TYPES OF R-CURVES**



**New in 2024!**

**SD-95-PN**

Retractable diamond sharpener with 3 sharpening edges, red/black

220 67

**GRIT #360 & #600**



**New in 2024!**

**SD-100-BT**

Foldable diamond sharpener with two types of grit, red

230 66



**GO-1**

Blade cleaner - 100ml

12

EAN 8715397010366



**GO-5**

Blade cleaner - 500ml

6

EAN 8715397009766



Cleaning detergent for pruning tools



EAN 4965280997159

**ARS9F-10**

Saw file 220 mm, wood

220 50 20/200



EAN 4965280445070

**SH-VSZ**

Universal leather holster

230 109 5/50





PR0011

Pen



PR0016

Notepad A6



PR0021

Mug



PR0031

Flag (119 x 84 cm)



PR0001

Cap, red/black



PR0002

Beanie, black



PR0056

Decal (30 x 16 cm)



PR0057

Decal (ø 20 cm)



PR0005-B-M

Medium

Polo-shirt, black

PR0005-B-L

Large

Polo-shirt, black

PR0005-B-XL

Extra large

Polo-shirt, black



PR0005-R-M

Medium

Polo-shirt, red

PR0005-R-L

Large

Polo-shirt, red

PR0005-R-XL

Extra large

Polo-shirt, red

## Pruning set ARS-10-S

The extra cheap ARS-10-S pruning set is composed of 2 top items from the the range. The GR-17 is a folding saw with a (interchangeable) blade from 175 mm and a total length of 375 mm. The saw blade is hardened chromed steel, with the unique ARS teeth setting.

The VS-8Z is a professional pruning shear with an overall length of 200 mm and a cutting thickness of 25 mm. The extra hardened, chrome-plated and interchangeable upper and lower blades, guarantee optimum cutting quality for a long period of time.

This professional set is packaged in a representative display box with a transparent lid.



ARS-10-S

VS-8Z &amp; GR-17





#### General terms and conditions of sale and delivery of Westparts B.V. in Wieringerwerf, The Netherlands

For the private owned company with limited responsibility WESTPARTS B.V., by law established in Hoom, with office space in 1771 SP Wieringerwerf, De Stek 7.

#### Article 1. Validity of these terms and conditions

These terms and conditions are valid for every offer and/or every agreement between Westparts B.V. hereinafter referred to as "Westparts", and customers who have been informed about the terms and conditions, as long as none of the parties have denied in writing the validity of the terms. If one or more articles are regarded as invalid, the remaining articles remain valid.

#### Article 2. Offers and agreements

- All offers are without obligations, unless otherwise explicitly agreed upon in writing. Westparts has the right to withdraw any given offer within two working days after acceptance.
- Agreements are valid only upon written confirmation from Westparts to the customer; this also concerns agreements made through an intermediary.

#### Article 3. Delivery

The customer is obligated to accept the products when these are delivered to him, or when the products are made available to him according to the agreement. If the customer refuses to do so, or is late with passing on information or instructions essential for the delivery, the products will be stored at the customer's risk. The customer will in this case be responsible for all possible costs in this connection, and at least the storage costs.

#### Article 4. Delivery time

Any dates quoted for delivery are approximate only, unless otherwise has been agreed upon. If otherwise has been agreed upon, and Westparts do not deliver on time, the customer is obligated to hold Westparts liable in writing.

#### Article 5. Back orders / partial deliveries

Westparts has the right to deliver partially. This does not apply if the partial delivery has no independent value. If the products are delivered partially, Westparts has the right to invoice each delivery independently.

#### Article 6. Technical requirements etc.

If the products delivered in the Netherlands are to be used outside the Netherlands, Westparts is responsible for that the delivered products are in accordance with the technical requirements and/or standards that are demanded by laws or regulations in the country where the products are to be used, if the information regarding use in another country has been given upon finalizing the contract. All other technical requirements the customer has regarding the to- be -delivered products and which differ from the normal standards, must be explicitly informed upon the finalizing of the contract.

#### Article 7. Changes

Westparts has the right to deliver products that differs from the products described in the sales contract:

If Westparts uses this right, and delivers a product that substantially differs from the product agreed upon, the customer has the right to annul the contract. The customer has the right to do so within 14 days after delivery date, or when he should have noticed the substantial differences.

#### Article 8. Termination of the contract

- Westparts' claims towards the customer are immediately effective in case of the following circumstances:
  - if after finalizing the agreement, Westparts receives information that gives Westparts reason to believe that the customer will not fulfil his obligations
  - if Westparts has asked the customer for security for the order when finalizing the contract, and security has not been given or is unsatisfactory.
 In case of the above mentioned circumstances, Westparts has the right to delay further execution of the agreement, as well as annul the agreement. This does not effect Westparts' rights for compensation.
- In case of unexpected circumstances having influence on persons and/or materials used or planned used by Westparts when carrying out the agreement, and if the unexpected circumstances are of such kind that it makes the execution impossible or utterly difficult, and/or leads to such costs that the carrying out of the agreement can not be reasonably defended, Westparts has the right to annul the agreement.

#### Article 9. Warranties

- Westparts is not responsible for production faults concerning the delivered goods.
- Westparts delivers goods with normal factory warranties and the production units are thus responsible in all cases.

#### Article 10. Ownership

- Products delivered by Westparts remains property of Westparts until the customer has fulfilled all responsibilities regarding all final contracts and agreements with Westparts:
  - any in return commitments with reference to delivered products or products to be delivered
  - potential claims due to the customer not having fulfilled his commitments according to the agreement
 Products delivered by Westparts falling under 10.1, can only be re-sold within a framework of a normal company management. The customer does not hold any authority to pawn or to establish any rights on the products.
- In case the customer does not live up to his responsibilities or there is a reasonable doubt regarding whether or not he will do so, Westparts has the right to remove or have removed products falling under article 10.1, from either the buyer or any third party holding the products in stock. The customer is legally bound to fully co-operate under penalty of a daily fine of 10% of the amount still to be paid
- If a third party wants to establish any rights on the under the rights of ownership delivered goods, the buyer is legally bound to inform Westparts as soon as in fairness can be expected.
- The customer is obliged to:
  - insure and to keep insured the under the rights of ownership delivered good against fire-, explosion-, and water damage and against theft and to hand over the insurance policy for inspection if requested to do so.
  - to pawn all claims from the customer to the insures in connection to the under the rights of ownership delivered goods, to Westparts in the way that is prescribed in art. 3:239 BW.
  - to pawn the demands that the customer gets towards his buyers from reselling under the rights of ownership delivered goods by Westparts, to Westparts in the way that is prescribed in art. 3: 239 BW.
  - to mark all under the rights of ownership delivered goods as Westparts property.
  - to lend cooperation in other ways to all reasonable measures that Westparts will take safeguarding her rights of ownership in connection with the goods and which do not unreasonably harm the customer in the normal practise of his company.

#### Article 11. Complaints

- The customer needs to (let) check the purchased goods up on delivery or as soon as possible after the delivery. The customer has to check if the delivered goods answers to the agreed upon, namely:
  - if the correct goods have been delivered
  - if the delivered goods answer to the agreed upon quantity
  - if the delivered goods meet the agreed upon quality requirements or
  - if these are lacking - if they do meet the demands one may have for normal use and/or commercial purpose
- If visible faults or shortages are established the customer has to inform Westparts within 8 days after delivery.
- Non visible faults have to be informed in writing within 8 days to Westparts, after the establishing of the faults, yet at the very latest within the given factory guarantee.
- Also when the customer complains in time, his obligation to payment and the purchase of the ordered goods stays valid. Goods can only be returned to Westparts after the foregoing permission in writing.

#### Article 12. Price increase

If Westparts has a special price agreement with a customer, Westparts nevertheless has the right to raise her prices, and has the right to charge the prices according to her valid pricelist upon delivery. If the price increase is more than 10%, the customer has the right to annul / disband the agreement.

#### Article 13. Packaging

The customer is obliged to return the transport packaging empty and undamaged within 30 days. If the customer does not meet his obligations with regards to the packaging, all extra costs to follow, will be for his own account. Such costs may be: costs due to late return shipment, costs of replacement, repair or cleaning.

#### Article 14. Payment

- Unless otherwise expressly stated payment for the goods is due no later than 30 days after invoice date:
  - by legal currency to Westparts bv
  - by transferring the due amount to the informed account numbers in property of Westparts
 If full payment is not made by the due date, the buyer will automatically be in omission, and will be charged with an extra 1% interest per month, based on the amount he has to pay.
- In case of liquidation, bankruptcy, delay of payment from the customer, the obligations will be immediate effective.
- Payment should be made without discounts or settlement.
- Payment made by customer will first serve to settle all unpaid interest and costs, and then to settle the oldest invoice due, even if the customer states that payment is meant for a later invoice.

#### Article 15. Collection costs

- If the customer is inadequately or neglectful in carrying out his obligations, all reasonable extra costs for collecting the payment will be for the customer's account. The minimum costs will be:
 

-Up till € 2.950,-	15%
-From above amount and up till € 5.900,-	10%
-From above amount and up till € 14.750,-	8%
-From above amount and up till € 58.990,-	5%
-From above amount and up	3%

 If Westparts can document higher costs made in connection with collecting the money, which were necessary and also reasonable, these costs will also be for the customer's account.
- All judicial and extrajudicial collection costs that Westparts makes, are all to be paid by customer. This is applicable only in case of a legal process

#### Article 16. Liability

Westparts is to the customer only liable:

- For damage due to shortcomings in the delivered goods concerns only the liability as settled in article 9 of these General Terms and Conditions,
- Westparts is liable if damage has been caused by intention or crude guilt of Westparts or her executive inferiors.
- The liability of Westparts is limited to the amount stated by the insurance, as far as the liability is covered by the insurance.
- If the insurance in any case does not cover or does not proceed with payment, the liability will be limited to the invoice amount or if no invoice is existing the value of the agreed upon achievement.

#### Article 17. Force Majeure

- Under force majeure is to be understood:
  - Circumstances that will unable the fulfillment of the agreement, which are not ascribable to Westparts. Among these the following will be included (if and as far as these circumstances make the fulfillment impossible or unreasonably complicated): strikes in other companies than Westparts', wild strikes or political strikes; general shortage or lack of necessary raw materials and other goods or services that are necessary to reach the agreed upon performance; not foreseen stagnation in connection with suppliers or other third parties who Westparts is depending on and general problems in transport.
 Westparts also has the right to refer to force majeure if circumstances that unable the fulfillment occur after Westparts should have met her obligations.
- During the period of force majeure the deliveries and other obligations of Westparts will be postponed. If this period due to force majeure which in Westparts is not able to meet her obligations, lasts longer than 3 months, both parties are entitled to annul the agreement, without any obligations with regards to compensation.
- If Westparts in the beginning of the period of force majeure already partially has fulfilled her obligations, or is able to fulfil her obligations only partially, Westparts has the right to invoice the partially delivered goods, or the goods that are to be partially delivered, and is the customer obligated to regard this invoice as a separate contract. This does not apply if the partial delivery has no independent value.

#### Article 18. Disputes

As a deviation from the statutory rules for the authorities of the civil court, all disputes between the customer and Westparts, as long as the court has the necessary authorities, will be settled by the Civil Court in Alkmaar. Nevertheless Westparts has the authority to summon the buyer to an according to the law or the applicable international treaty qualified court.

#### Article 19. Applicable law

All relationships between Westparts and the customer will be governed by Dutch law.

#### Article 20. Changes in the General terms and conditions

Westparts has the right to change the General terms and conditions. The changes will come into force on the announced time of commencement. Westparts will send the renewed terms and conditions to the customers in time. If no time of commencement has been announced to the customer, the changes will come into force as soon as the customer has received the announcement.

#### Article 21. Translations

In case of conflict between a translation and the Dutch version of these terms and conditions, the Dutch text shall prevail.

The above terms and conditions have been deposited with the Chamber of Commerce at Alkmaar under number 36040554.1781





***Cut Above the Rest***

**www.arstools.eu**

**ARS Tools**

De Stek 7  
1771 SP, Wieringerwerf  
The Netherlands

**Contact us**

+31 (0)227 60 15 00  
sales@arstools.eu



Find your nearest  
ARS Tools dealer at

[dealers.arstools.eu](https://dealers.arstools.eu)

